

## PSB2 Sensor Bracket

### Instruction & Maintenance Manual

### PSB2 传感器支架安装使用维护手册

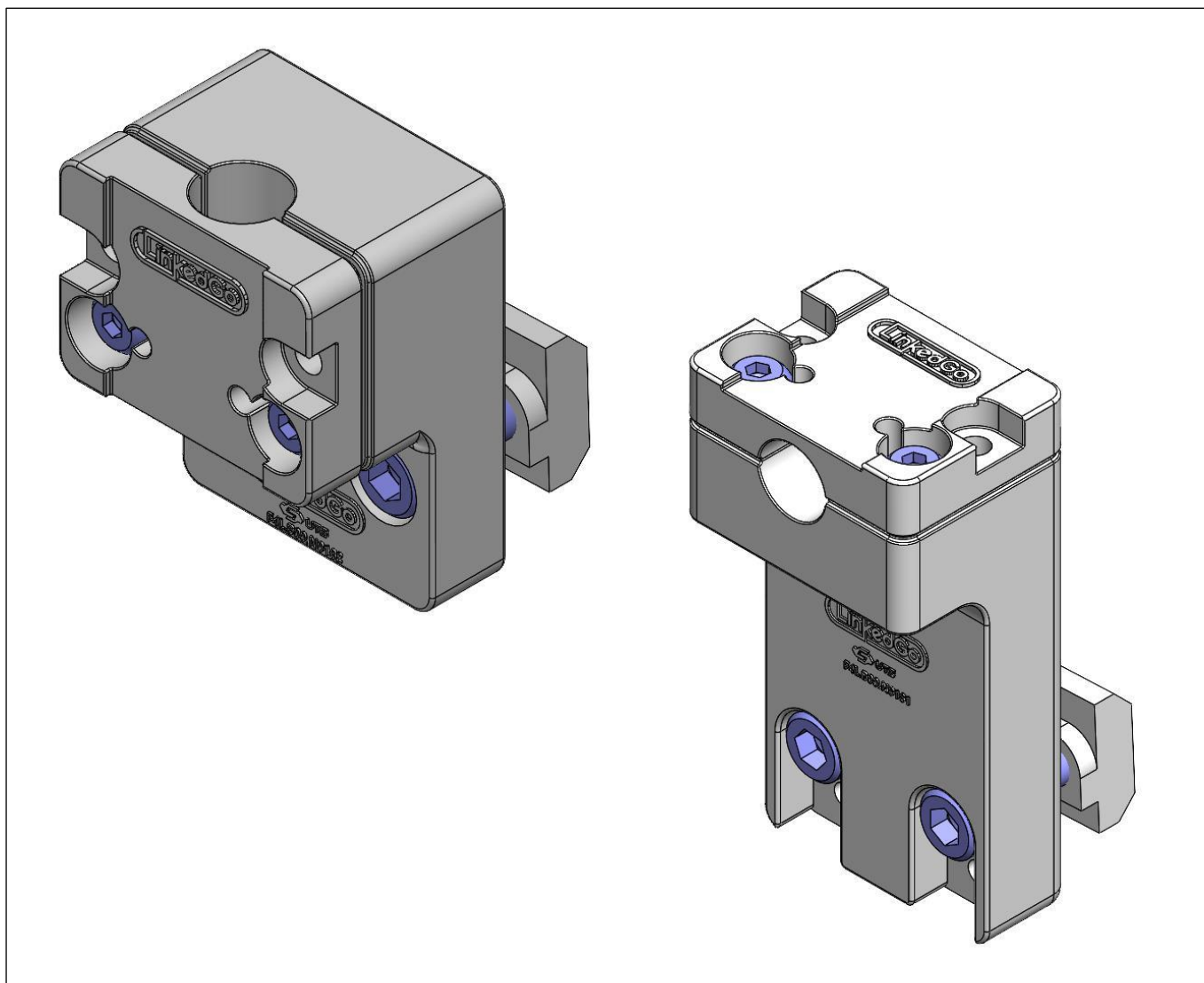

Structure Diagram 结构示意图

PSB2/O

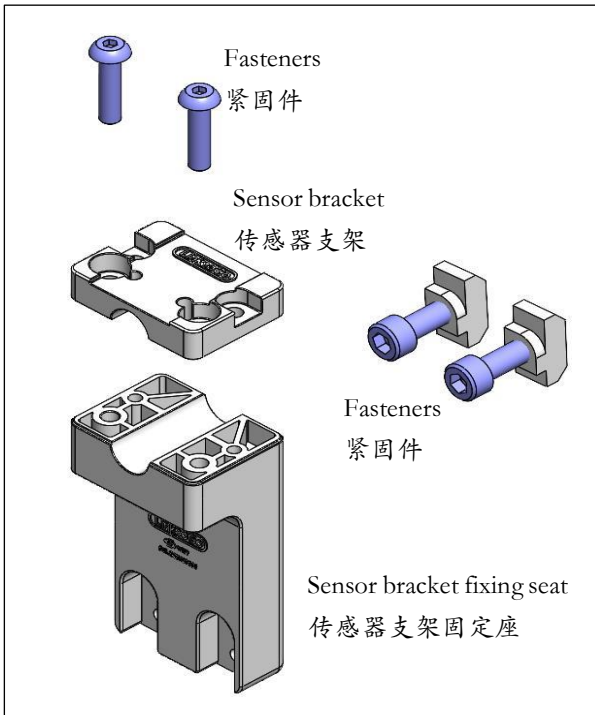

PSB2/I

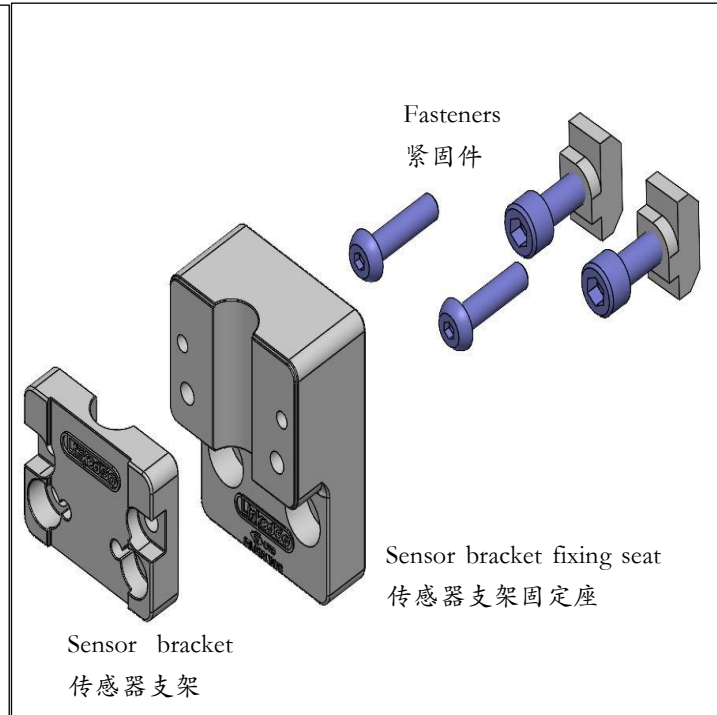

产品特征

安装步骤

1. The switch bracket can fix the position of the workpiece tray, and the side sensing application sensor M12x1.
- 1、开关支架可固定工件托盘位置侧面感应用传感器 M12x1。
2. Used to secure sensors.
- 2、用于固定传感器。
3. Suitable for side sensing of workpiece tray position.
- 3、适合于工件托盘位置的侧面感应。
4. Installed on the locking pit on the side of the conveying section.
- 4、安装在输送段侧边的上锁坑上。

维护保养

安装步骤 Installation steps

A. Assemble the PSB2/O sensor bracket.

A 组装 PSB2/O 传感器支架。

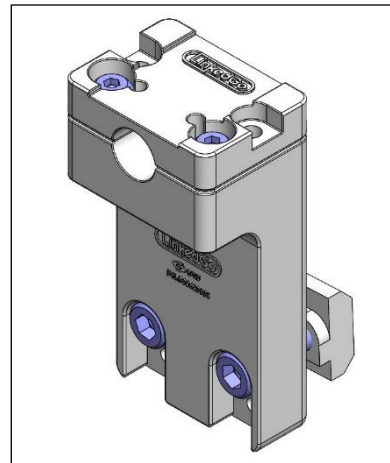
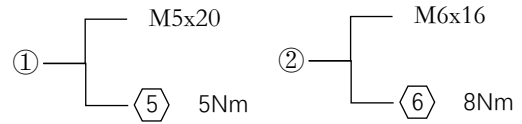
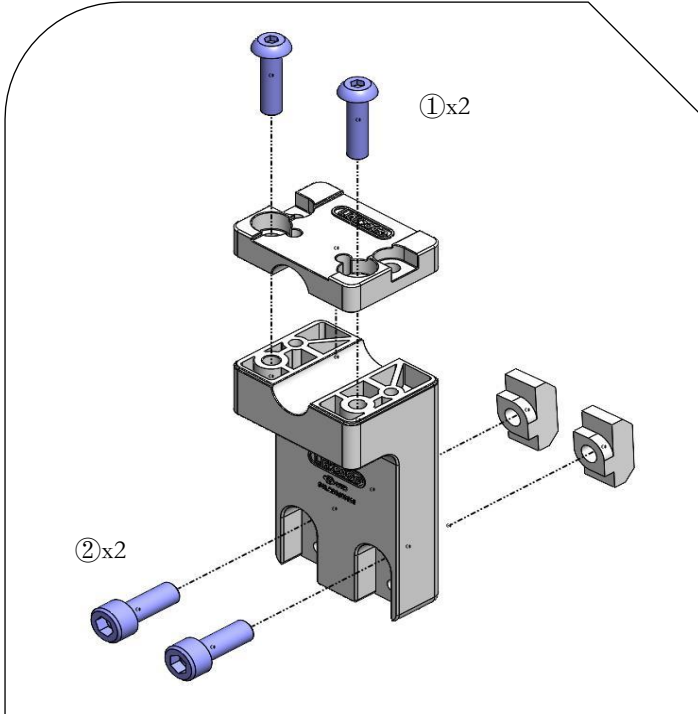

B. Assemble the PSB2/I sensor bracket.

B、组装 PSB2/I 传感器支架。

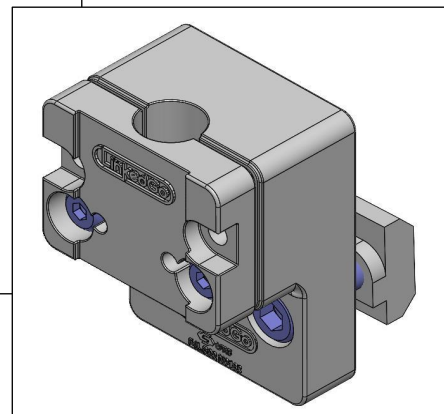
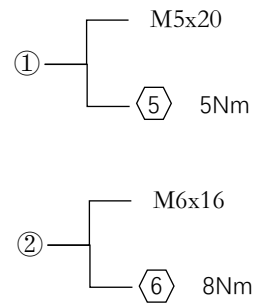
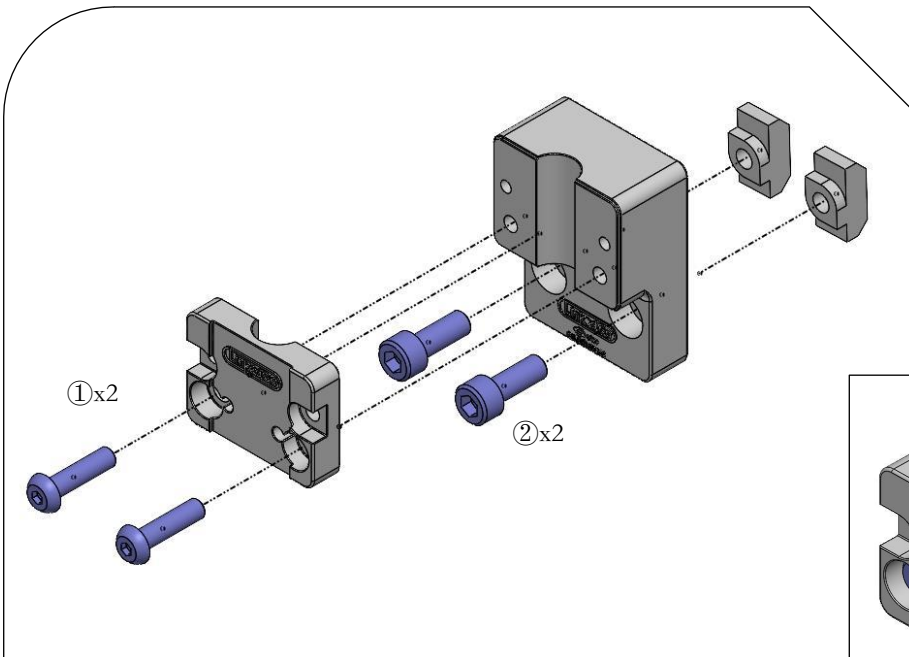

产品特征

安装步骤

维护保养

C Install to the wire body.

C 安装至线体。

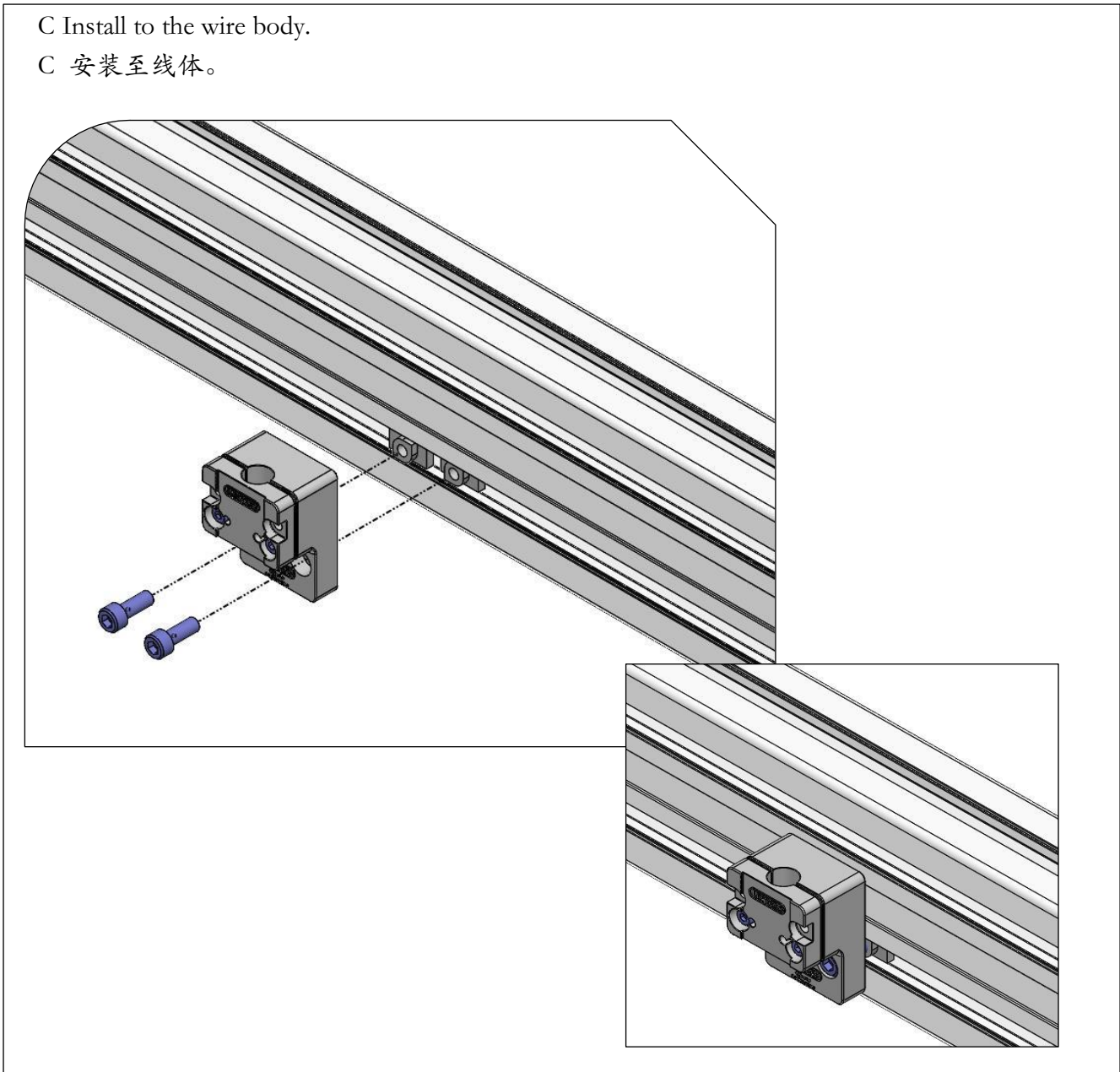

产  
品  
特  
征

安  
装  
步  
骤

维  
护  
保  
养

Disclaimer

免责声明

The customer shall inspect the equipment regularly. If the customer fails to maintain the conveyor as the state above, leading to any malfunction or damage to the conveyor, our company will not be responsible for it, all related costs (including material costs, installation and commissioning fees, and hotel expense) shall be borne by the customer.

客户应定期对设备进行检查。若客户未按要求对输送机进行维护，进而导致输送机发生任何故障或损坏，我司将不承担相关责任，由此产生的相关费用（材料费，安装调试费，差旅费）均由客户承担。

Suzhou LinkedGo Transfer System Co.,Ltd.  
苏州领科工业技术有限公司

[Tel: +86-512-6636 1885](tel:+86-512-66361885)

Add: Room 706, Building D, Dongchuang Science and Technology Park,  
No. 216 Jinfeng Road, Wuzhong District, Suzhou, P.R. China  
Zip code:215101

E-mail: [Sales@LinkedGo.com.cn](mailto:Sales@LinkedGo.com.cn)

Website: [www. LinkedGo.com.cn](http://www.LinkedList.com.cn)

Subject to technical modifications

电话：+86-512-6636 1885

地址：苏州市吴中区木渎镇金枫路 216 号东创科技园 D 幢 706 室

邮编：215101

邮箱：[Sales@LinkedGo.com.cn](mailto:Sales@LinkedGo.com.cn)

网址：[www.LinkedList.com.cn](http://www.LinkedList.com.cn)

我司保留技术更改的权利